



Doug Mitchell
509.925.1501
www.jdmitchellhomes.com

category A

► **D M Construction, Inc.**

Nestled in the hills of Badger Pocket, this farm house style home was designed and sited for its spectacular views of Mt. Rainier and the Mt. Stewart Range. The tiled entry opens to a soaring great room. The wood beamed ceiling and rock fireplace evoke the tradition of the Northwest lodge. Custom built beech cabinets and knotty alder doors add a warm and rustic touch. The tile and natural maple floors are perfect for an active household. The gourmet kitchen features stainless steel appliances, granite countertops and a copper farm sink. A wood ceiling and rock fireplace in the owner's suite create the mood for a perfect retreat. Outside, friends and family can enjoy the view from a spacious brick patio. The upstairs family room with its small kitchen and fireplace are among the many amenities offered to the energetic family.

D M Construction, Inc. has been building award winning homes in Kittitas County for over fifteen years. We have earned a reputation for designing and building homes that are functional, spacious and beautiful.

► **Main Level**

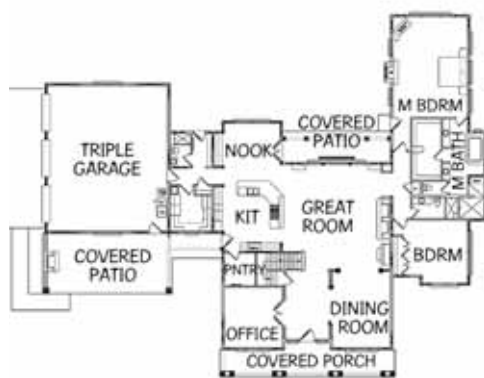

► **Upper Level**



DIRECTIONS: From Interstate Highway 90 take Interstate Highway 82 south. Take exit #3 and turn east onto Thrall Road. Continue on Thrall Road for several miles then turn right on L. Wilson Road. Go to the next stop sign and turn left on 4th Parallel Road. The home is located at the very end of 4th Parallel Road.

