



Home Builder
Harley C. Douglass, Inc.
Spokane, Washington
509-487-9792

509-487-9792 • Harley Douglass

Golden Pond

11608 N Ashley, Spokane, WA

Directions: Divison & Hawthorne, North on Hawthorne to Wakki Road, West on Wakki Road, Past Spokane Country Boulevard, next to St. George's Entry Way.

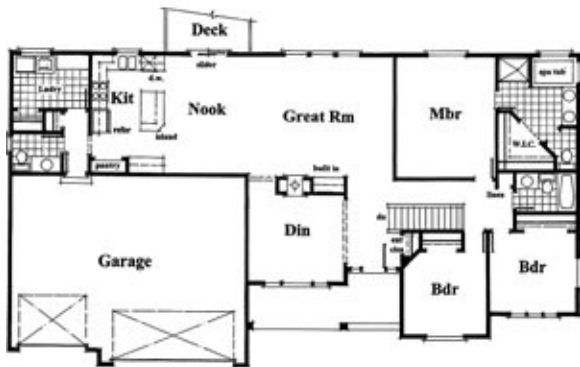

Harley C. Douglass, Inc.



- Beautiful Craftsman Exterior
- Great Room - Floor to Ceiling Fireplace with Hearth
- Distressed Ash Cabinetry

Fall Festival of Homes Price: \$469,950

3 Bedroom, 3 Bathrooms, 2014 Square Feet